

VHM *Special inserts*

Aprilia **RS125 streetbike**

Partnumber insert	Brand	Type	Year from	Year till	Description	Volume [cc]	Piston height [mm]	Squish [mm]
AE32008-A	Aprilia	RS125 streetbike			Blind insert			
AE32008-B	Aprilia	RS125 streetbike				11.50	+2.00	1.40
AE32008-xxx	Aprilia	RS125 streetbike			Special insert according to your specification			



Aprilia **RS125/250 RSW racebike** **Type APC**

Partnumber insert	Brand	Type	Year from	Year till	Description	Volume [cc]	Piston height [mm]	Squish [mm]
AE32076-A	Aprilia	RS125 / RS250 racebike, APC			Blind insert			
AE32076-AC39	Aprilia	RS125 / RS250 racebike, APC				11.37	+1.50	0.75
AE32076-AC32	Aprilia	RS125 / RS250 racebike, APC				11.22	+1.50	0.75
AE32076-AC37	Aprilia	RS125 / RS250 racebike, APC				11.10	+1.50	0.75
AE32076-AC38	Aprilia	RS125 / RS250 racebike, APC				10.90	+1.50	0.75
AE32076-AC56	Aprilia	RS125 / RS250 racebike, APC				10.77	+1.50	0.75
AE32076-AC68	Aprilia	RS125 / RS250 racebike, APC				10.64	+1.50	0.75
AE32076-AC69	Aprilia	RS125 / RS250 racebike, APC				10.50	+1.50	0.75
AE32076-xxxx	Aprilia	RS125 / RS250 racebike, APC			Special insert according to your specification			



Aprilia **RS125/250 RSW racebike** **Type APE**

Partnumber insert	Brand	Type	Year from	Year till	Description
AE32085-A	Aprilia	RS125 / RS250 racebike, APE			Blind insert
AE32085-xxxx	Aprilia	RS125 / RS250 racebike, APE			Special insert according to your specification



Derbi **50cc / 70cc**

Partnumber insert	Brand	Type	Year from	Year till	Description
AE32135-A	Derbi	50cc			Blind insert
AE32135-xxx	Derbi	50cc			Special insert according to your specification
AE32144-A	Derbi	70cc			Blind insert
AE32144-xxx	Derbi	70cc			Special insert according to your specification



VHM *Special inserts*

GasGas **65cc**

Partnumber insert	Brand	Type	Year from	Year till	Description
AE32118-A	GasGas	65cc			Blind insert
AE32118-xxx	GasGas	65cc			Special insert according to your specification



lame **125 Screamer**

Partnumber insert	Brand	Type	Year from	Year till	Description
AE32246-A	lame	125 Screamer			Blind insert
AE32246-xxx	lame	125 Screamer			Special insert according to your specification



Malossi **Minarelli AM6, scooter 7T**

Partnumber insert	Brand	Type	Year from	Year till	Description
AE32191-A	Malossi	50cc Minarelli AM6, scooter 7T			Blind insert
AE32191-xxx	Malossi	50cc Minarelli AM6, scooter 7T			Special insert according to your specification
AE32173-A	Malossi	Minarelli AM6, scooter 7T, pitch 50x50 and 52x52			Blind insert
AE32173-xxx	Malossi	Minarelli AM6, scooter 7T, pitch 50x50 and 52x52			Special insert according to your specification
AE32173B-A	Malossi	Minarelli AM6, scooter 7T, pitch 54x54 and 56x56 (Derbi)			Blind insert
AE32173B-xxx	Malossi	Minarelli AM6, scooter 7T, pitch 54x54 and 56x56 (Derbi)			Special insert according to your specification



Malossi **Piaggio**

Partnumber insert	Brand	Type	Year from	Year till	Description
AE32172-A	Malossi	Piaggio			Blind insert
AE32172-xxx	Malossi	Piaggio			Special insert according to your specification



Modena **125**

Partnumber insert	Brand	Type	Year from	Year till	Description
AE32234-A	Modena	125			Blind insert
AE32234-xxx	Modena	125			Special insert according to your specification



VHM *Special inserts*

Pavesi 125

Partnumber insert	Brand	Type	Year from	Year till	Description
AE32055-A	Pavesi	125			Blind insert
AE32055-xxx	Pavesi	125			Special insert according to your specification

Note: does not fit the standard cylinder headcover, VHM modification on the headcover needed.



Polini Minarelli

Partnumber insert	Brand	Type	Year from	Year till	Description
AE32091-A	Polini	Minarelli			Blind insert
AE32091-xxx	Polini	Minarelli			Special insert according to your specification



TM K9B, K9C, KZ10, KZ10B

Partnumber insert	Brand	Type	Year from	Year till	Description	Volume [cc]	Piston height [mm]	Squish [mm]
AE32203-A	TM	K9B, K9C, KZ10, KZ10B	2008	2015	Blind insert			
AE32203-xxx	TM	K9B, K9C, KZ10, KZ10B	2008	2015	Special insert according to your specification			
AE32203-277	TM	KZ10	2010	2011	4° piston APTM12521704	13.80 (13.20 CIK)	-2.20	1.05 mm 5.5°
AE32203-278	TM	KZ10	2012		4° piston APTM12521704	13.80 (13.20 CIK)	-2.30	1.05 mm 5.5°
AE32203-279	TM	KZ10B	2013	2015	4° piston APTM12521704	13.80 (13.20 CIK)	-2.40	1.05 mm 5.5°
AE32203-334	TM	KZ10	2010	2011	VHM flat top radius piston: APTM12521718	13.80 (13.20 CIK)	-3.55	0.85 mm
AE32203-335	TM	KZ10	2012		VHM flat top radius piston: APTM12521718	13.80 (13.20 CIK)	-3.65	0.85 mm
AE32203-336	TM	KZ10B	2013	2015	VHM flat top radius piston: APTM12521718	13.80 (13.20 CIK)	-3.75	0.85 mm

Note: VHM inserts does not fit the standard cylinder headcover (CYLTMKZ10), VHM modification on the headcover needed: **MODCYLKOP-001**



TM K9B, K9C, KZ10, KZ10B

Partnumber	Year	Partnumber
OEM Cylinder head cover		Modification cylinder head cover for using VHM inserts AE32203-xxx
CYLTMKZ10	2008 - 2015	MODCYLKOP-001



VHM *Special inserts*

TM		KZ10C						
Partnumber insert	Brand	Type	Year from	Year till	Description	Volume [cc]	Piston height [mm]	Squish [mm]
AE32270-A	TM	KZ10C	2016	→	Blind insert			
AE32270-026	TM	KZ10C	2016	→		13.80 (13.20 CIK)	-2.20	0.90 mm
AE32270-027	TM	KZ10C	2016	→		13.80 (13.20 CIK)	-2.30	0.90 mm
AE32270-028	TM	KZ10C	2016	→	STD	13.80 (13.20 CIK)	-2.40	0.90 mm
AE32270-029	TM	KZ10C	2016	→		13.80 (13.20 CIK)	-2.50	0.90 mm
AE32270-030	TM	KZ10C	2016	→		13.80 (13.20 CIK)	-2.60	0.90 mm
AE32270-012	TM	KZ10C	2016	→	For flat top radius piston: APTM12521718	13.80 (13.20 CIK)	-3.75	0.85 mm
AE32270-xxx	TM	KZ10C	2016	→	Special insert according to your specification			

Note: VHM inserts fit the standard cylinder headcover CYLTMKZ10C without any modifications.



TM **KZ10C**

Partnumber	Year
OEM Cylinder head cover	2016 →
CYLTMKZ10C	2016 →



The compression ratio can be adjusted quickly, by increasing or decreasing the volume of the combustion chamber, depending on the track and weather conditions. The inserts are made of a special aluminum alloy which has a very good heat transference. Another advantage of the material is its resistance to detonation.

A higher compression ratio, which means less volume, will give the engine more low and middle range torque. This will improve the acceleration and increased torque feeling when accelerating out of the corner.

Lowering the compression ratio, which means more volume, will result in better overrevolution characteristics. We advise MX drivers to use inserts with a bigger volume on fast tracks to improve topspeed.

We give you the possibility to make your own combustion chamber according to your specifications. We have blind inserts available for all our cylinder headsets. This allows you to turn the combustion chamber profile and shape by your own.

We can also produce an insert according to your specifications, just give us the volume, piston height, squish and we have your special insert ready within 24 hours!

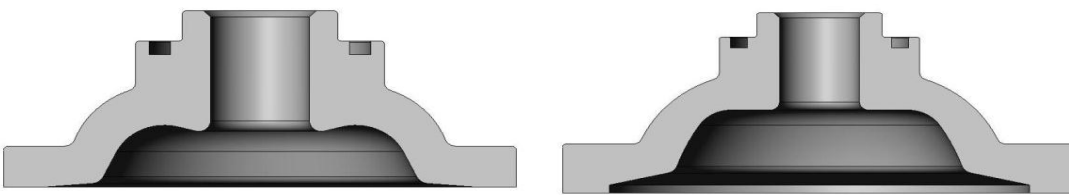

Fig. 1 Example custom insert with different shape of combustion chamber



Fig. 2 Various custom insert with different shape and dimension of combustion chamber
